

SIDE VIEW:

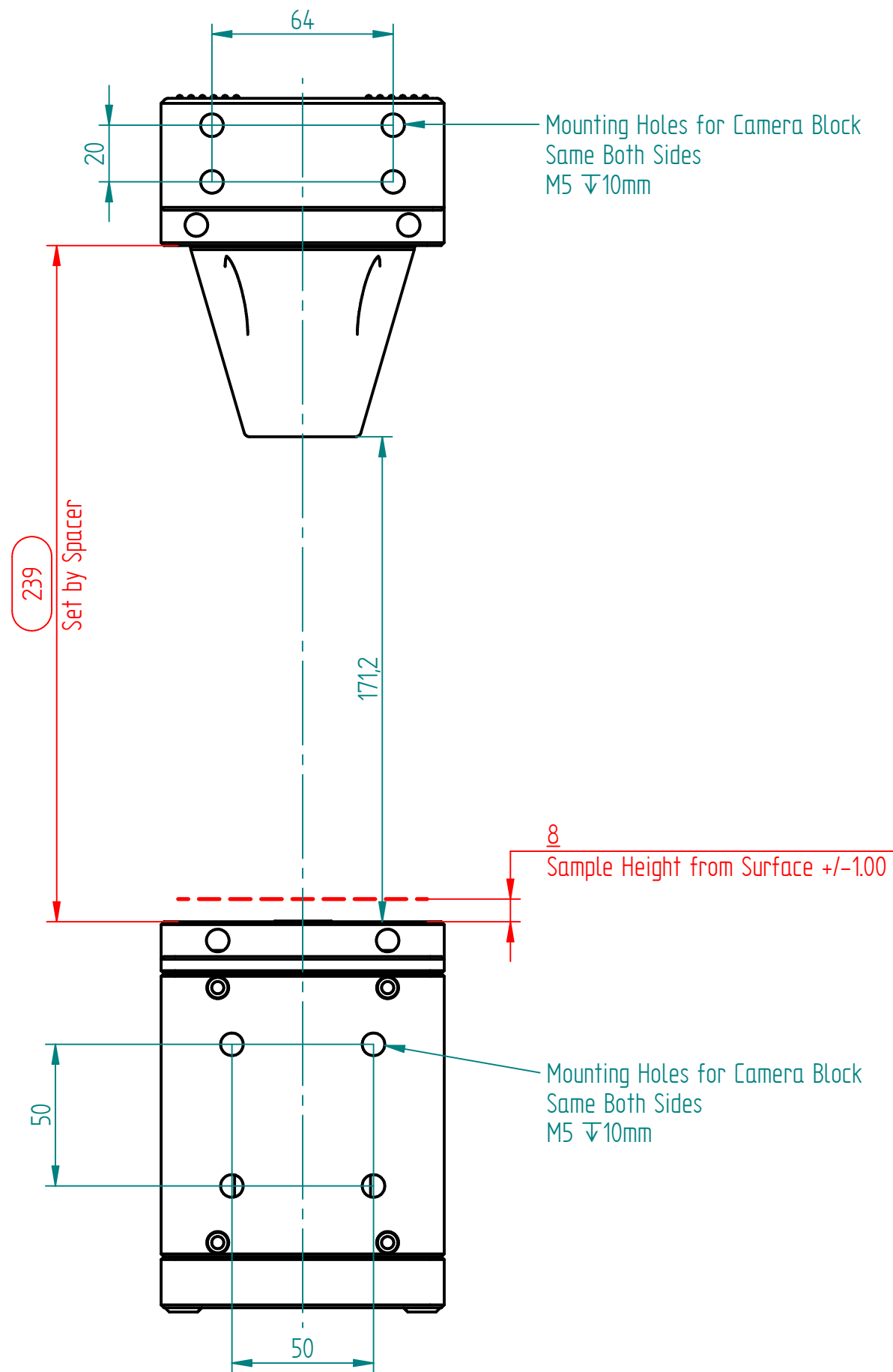

Spacer Removal

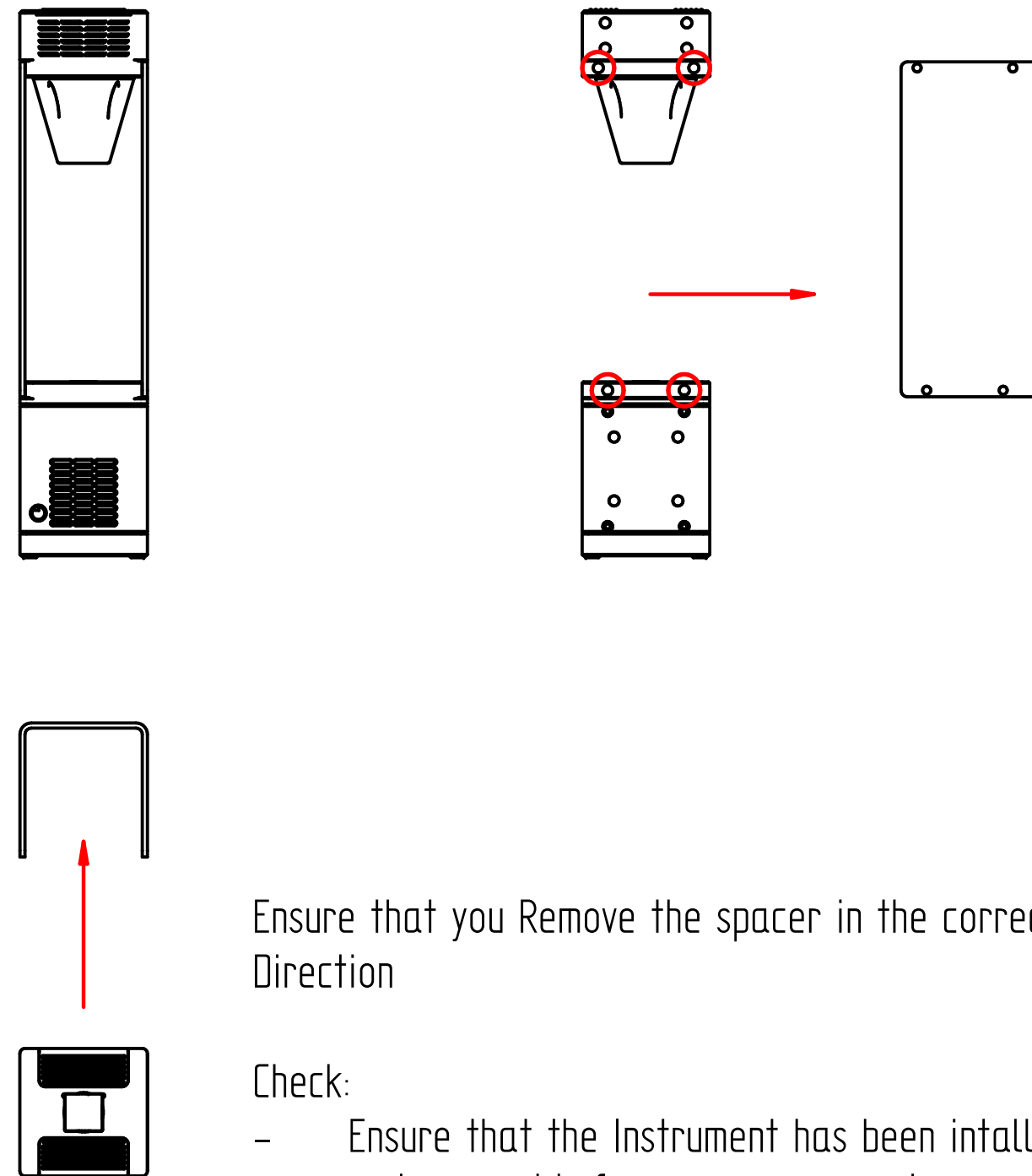

Ensure that you Remove the spacer in the correct Direction

- Check:
- Ensure that the Instrument has been intalled and secured before spacer removal
 - Ensure that the 8 Screws have been removed before removing the spacer (RED circles, BOTH Sides).

NOTE: All Measurements given are in Millimeters